

# OWNER'S MANUAL "CAPTIVA"

ELECTRIC FIREPLACE:  
WALL MOUNTED / BUILT-IN



NOBLE FLAME

CE AC 220-240V 50HZ 1400-1600W

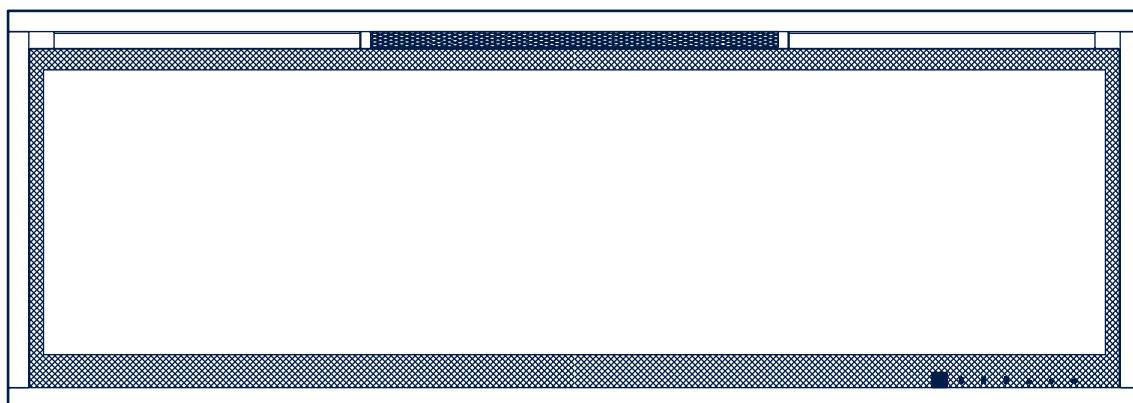

## ☒ MODEL

- |                                     |                                     |                                      |
|-------------------------------------|-------------------------------------|--------------------------------------|
| <input type="checkbox"/> 1020 (40") | <input type="checkbox"/> 1530 (60") | <input type="checkbox"/> 2140 (84")  |
| <input type="checkbox"/> 1280 (50") | <input type="checkbox"/> 1830 (72") | <input type="checkbox"/> 2540 (100") |

## ☐ CAUTION

- › Read and understand this entire owner's manual, including all safety information, before plugging in or using this product. Failure to do so could result in fire, electric shock, or serious personal injury.
- › Keep this owner's manual for future reference. If you sell or give this product away, make sure this manual accompanies this product.

## IMPORTANT SAFETY INFORMATION!

SAVE THESE INSTRUCTIONS!

- › **Read all instructions before using this heater!**

### CAUTION

- › **This heater is hot when in use.** To avoid burns, **DO NOT** let bare skin touch hot surfaces. If provided, use handles when moving this heater. Keep combustible materials, such as furniture, pillows, bedding, papers, clothes, and curtains at least 3 feet (0.9m) from the front of the heater, and keep them away from the sides and rear.
- › Extreme caution is necessary when any heater is used by or near children or invalids and whenever the heater is left operating and unattended.
- › **DO NOT** operate any heater with a damaged cord or plug or after the heater malfunctions, has been dropped or damaged in any manner. Discard heater, or return to authorized service facility for examination and/or repair.
- › **DO NOT** run power cord under carpeting. **DO NOT** cover power cord with throw rugs, runners, or similar coverings. **DO NOT** route power cord under furniture or appliances. Arrange power cord away from traffic area, and where it will not be tripped over.
- › Connect to properly grounded outlets **ONLY**.
- › **DO NOT** insert or allow foreign objects to enter any ventilation or exhaust opening, as this may cause electric shock or fire, or damage the heater.

### CAUTION

- › **To prevent a possible fire, DO NOT block air intakes or exhaust in any manner. Doing so could cause a fire. DO NOT use on soft surfaces, like a bed, where openings may become blocked.**
- › A heater has hot and arcing or sparking parts inside. **DO NOT** use it in areas where gasoline, paint, or flammable liquids are used or stored.

### CAUTION

- › **Use this heater ONLY as described in this manual. Any other use not recommended by the manufacturer may cause fire, electric shock, or injury to persons.**
- › **ALWAYS** plug heaters directly into a wall outlet/receptacle. **NEVER use with an extension cord or relocatable power tap (outlet/power strip).**
- › **DO NOT** place the heater near a bed because objects such as pillows or blankets can fall off the bed and be ignited by the heater.
- › **NEVER** use this heater in bathrooms, laundry rooms, or any other location where the heater could fall into a bathtub or pool, become damp, or get in contact with water.
- › **AVOID FIRE!** Regularly inspect all air vents to make sure they are free from dust, lint, or other blockage. Unplug the unit and clean with a vacuum **ONLY**. **DO NOT** rinse or get wet.
- › **ALWAYS** mount to wall bracket before use. **DO NOT** set on the floor, or other surface, to use.
- › **NEVER** use a wall mount bracket from another manufacturer.

## IMPORTANT SAFETY INFORMATION!

SAVE THESE INSTRUCTIONS!

- › This product is not intended to be a primary heat source. **It is for supplemental heat only.**

### CAUTION

- › **INDOOR use only! Never use this heater outdoors! Doing so may result in electric shock!**

### CAUTION

- › **Risk of electric shock! Do Not OPEN! No user-serviceable parts inside!**

- › **ALWAYS** turn this heater off before unplugging it from the outlet.
- › **ALWAYS** disconnect this unit from the power supply before performing any assembly or cleaning, or before relocating the electric fireplace.

### CAUTION

- › **Never leave this heater unattended. Always unplug this heater when not in use.**

- › **ALWAYS** store this heater in a dry location. **NEVER** use the fireplace if it has become wet.
- › **NEVER** plug this heater into an outlet that is old, cracked, or has any loose wires or connections. Plugging this heater into a faulty outlet could result in electric arcing within the outlet that could cause the outlet to overheat or catch fire.
- › **ALWAYS check your heater cord and plug connections with each use!**
  - a. **MAKE SURE the plug fits tight in the outlet!** Faulty wall outlet connections or loose plugs can cause the outlet to overheat.
  - b. Heaters draw more current than small appliances. Overheating may occur even if it has not occurred with the use of other appliances.
  - c. During use check frequently to see if the plug outlet or face plate is **HOT!**
  - d. If the outlet or face plate is **HOT, discontinue use immediately and have a qualified electrician inspect and/or replace the faulty outlets.**

## PREPARATION

### ⚠ CAUTION

- › This product includes a GLASS panel! Always use extreme caution when handling glass. Failure to do so could result in personal injury or property damage.
- › Remove all parts and hardware from the carton and place them on a clean, soft, dry surface. Parts and assembly steps are grouped for wall-hanging or recessing use. Check the parts list to make sure nothing is missing. Dispose of packaging materials properly. Please recycle whenever possible.
- › You will need the following tools (not included):
  - › Phillips screwdriver
  - › stud finder
  - › level
  - › tape measure
  - › electric drill
  - › 1/4" wood drill bit
  - › hammer

## PARTS & HARDWARE

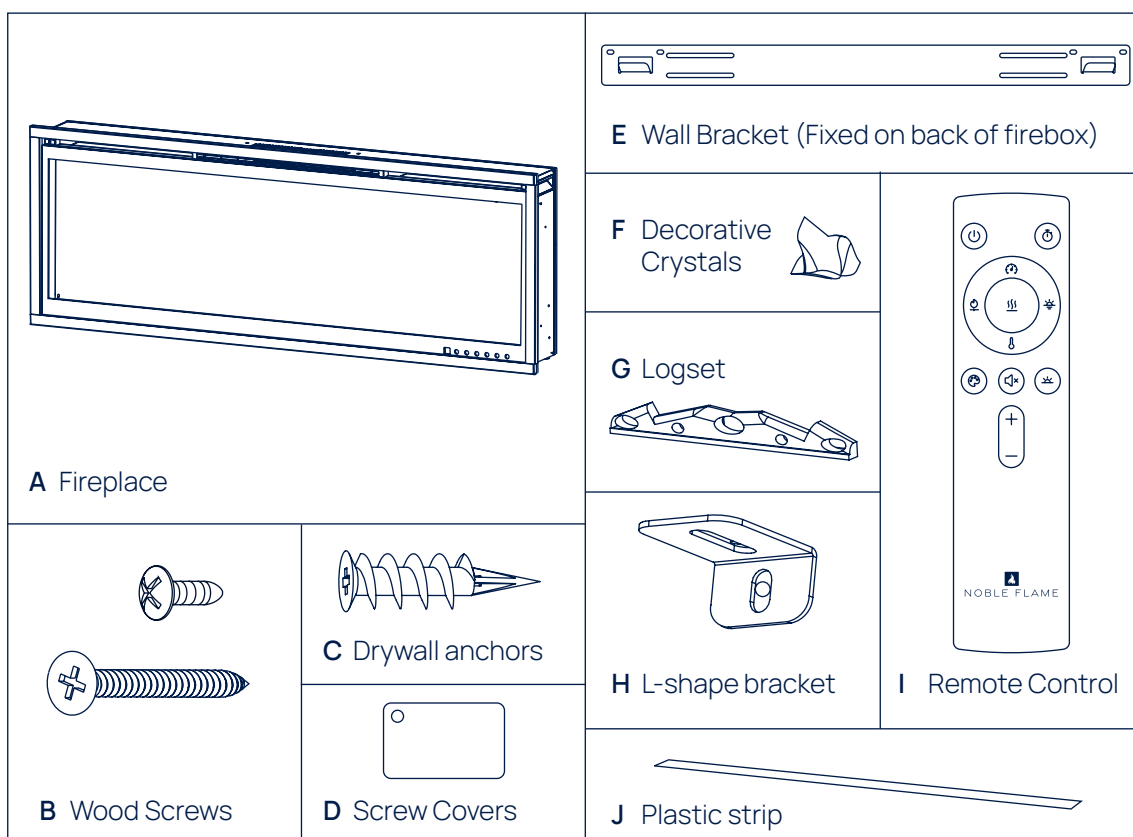

## SPECIFICATION & DIMENSION

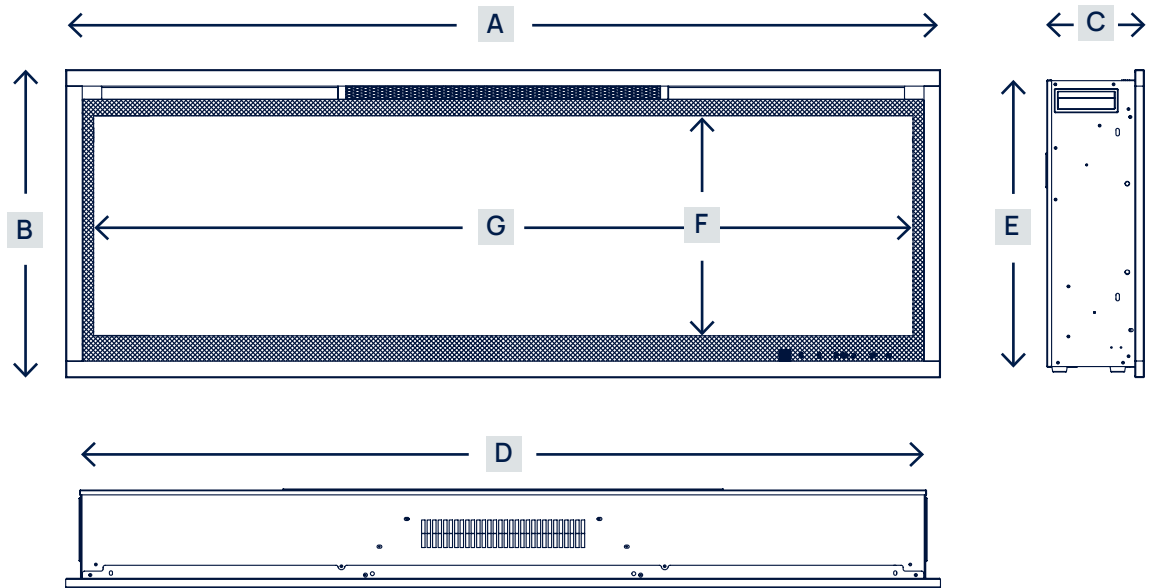

MODEL	A	B	C	D	E	F	G
<b>1020</b>	40" 101.7 cm	17 5/8" 44.8 cm	5 3/4" 14.6 cm	38 1/2" 97.8 cm	16 1/2" 41.8 cm	12 5/8" 32 cm	36 7/8" 93.6 cm
<b>1280</b>	50" 127.1 cm	17 5/8" 44.8 cm	5 3/4" 14.6 cm	48 1/2" 123.2 cm	16 1/2" 41.8 cm	12 5/8" 32 cm	46 7/8" 119 cm
<b>1530</b>	60" 152.5 cm	17 5/8" 44.8 cm	5 3/4" 14.6 cm	58 1/2" 148.6 cm	16 1/2" 41.8 cm	12 5/8" 32 cm	56 7/8" 144.4 cm
<b>1830</b>	72" 183 cm	17 5/8" 44.8 cm	5 3/4" 14.6 cm	70 1/2" 179.1 cm	16 1/2" 41.8 cm	12 5/8" 32 cm	68 7/8" 174.9 cm
<b>2140</b>	84" 213.5 cm	17 5/8" 44.8 cm	5 3/4" 14.6 cm	82 1/2" 209.6 cm	16 1/2" 41.8 cm	12 5/8" 32 cm	80 7/8" 205.4 cm
<b>2540</b>	100" 254.2 cm	17 5/8" 44.8 cm	5 3/4" 14.6 cm	98 1/2" 250.3 cm	16 1/2" 41.8 cm	12 5/8" 32 cm	96 7/8" 246.1 cm

INSTALLATION & ASSEMBLY

INSTALLATION

- NOTICE

CAUTION
- › Your appliance is a wall-mounted, recessed and/or mantel installed appliance. Select a suitable location that is not susceptible to moisture and is away from drapes, furniture and high traffic areas.

› Follow all national and local electrical codes.

› WHEN USING PAINT OR LACQUER TO FINISH THE MANTEL, THE PAINT OR LACQUER MUST BE HEAT RESISTANT TO PREVENT DISCOLOURATION.

MINIMUM CLEARANCE TO COMBUSTIBLES

MEASUREMENTS ARE TAKEN FROM THE GLASS FRONT			
BOTTOM	0 mm (0")	TOP	300 mm (11.8") to mantel
SIDES	0 mm (0")	TOP	300 mm (11.8") to ceiling
BACK	0 mm (0")		

SIDE VIEW

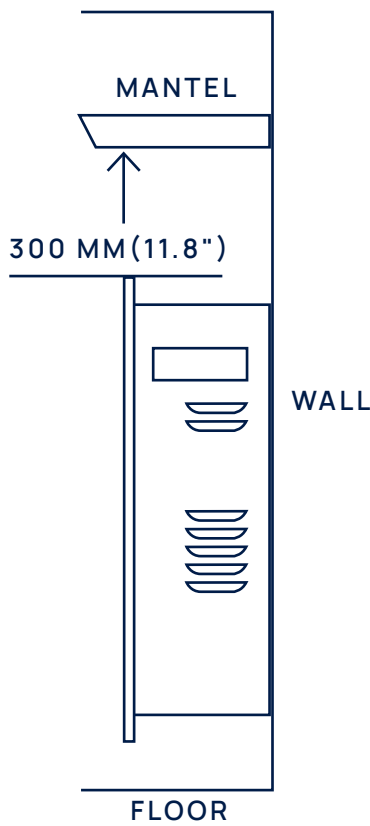

INSTALLATION & ASSEMBLY

RECESSED INTO WALL INSTALLATION

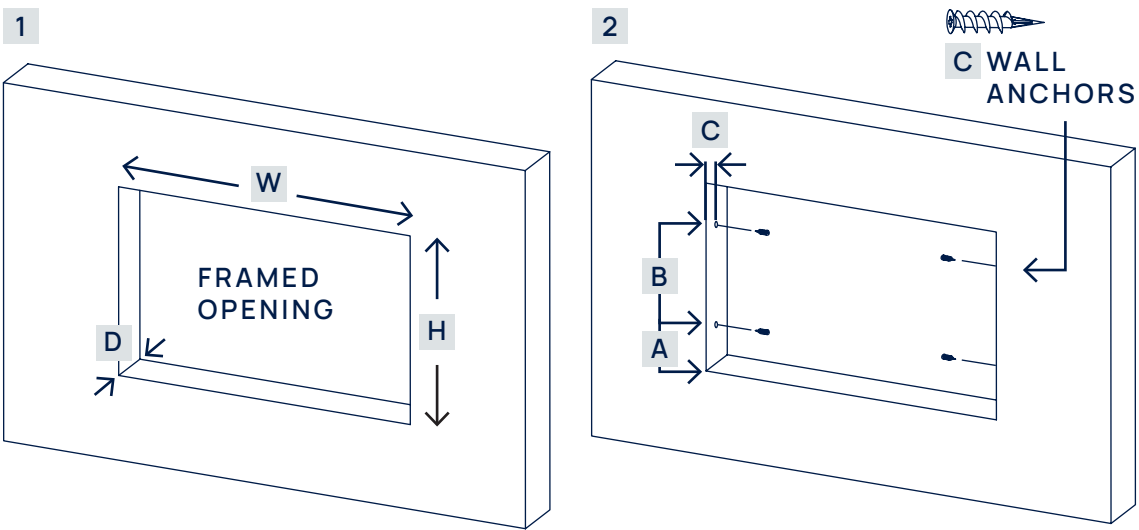

STEP 1

➤ Prepare a wall with an opening (Figure 1) with the dimensions listed in the chart below.

MODEL	W	H	D
1020	38 3/4" (98.4 cm)	16 3/4" (42.6 cm)	5 1/2" (14 cm)
1280	48 3/4" (123.8 cm)	16 3/4" (42.6 cm)	5 1/2" (14 cm)
1530	58 3/4" (149.2 cm)	16 3/4" (42.6 cm)	5 1/2" (14 cm)
1830	70 3/4" (177.8 cm)	16 3/4" (42.6 cm)	5 1/2" (14 cm)
2140	82 3/4" (210.2 cm)	16 3/4" (42.6 cm)	5 1/2" (14 cm)
2540	98 3/4" (250.8 cm)	16 3/4" (42.6 cm)	5 1/2" (14 cm)

STEP 2

➤ Drill two holes (Ø 1/2" [12.5 mm]) to install the wall anchors in each side of the framed opening according to the dimensions in Figure 2.

MODEL	INCHCES	CM
A	4 1/4"	10.8 cm
B	9 7/16"	24 cm
C	1 3/16"	3 cm

# INSTALLATION & ASSEMBLY

## RECESSED INTO WALL INSTALLATION

### STEP 3

- › Remove the screws from each side of the glass panel as shown in Figure 3.

3

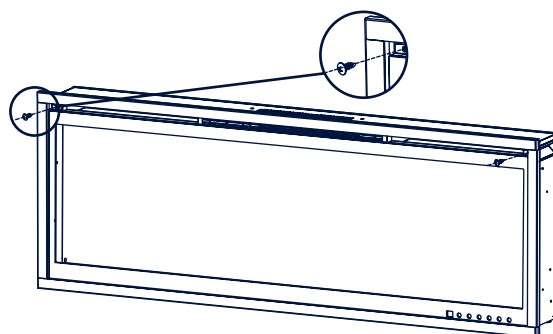

### STEP 4

- › Carefully remove the glass cover (Figure 4) with two people and place it on a soft and clean surface.

4

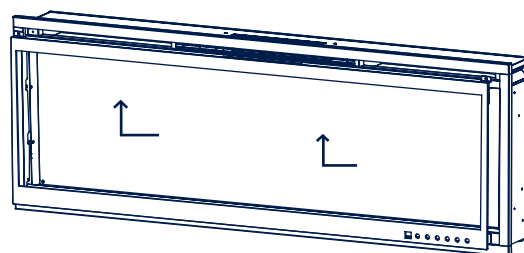

### STEP 5

- › Remove the two screws from each side (Figure 5). Then, remove the two metal brackets from each side (Figure 6).

5

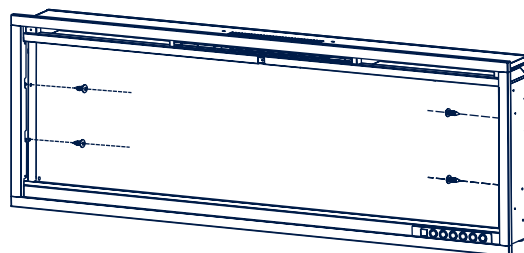

6

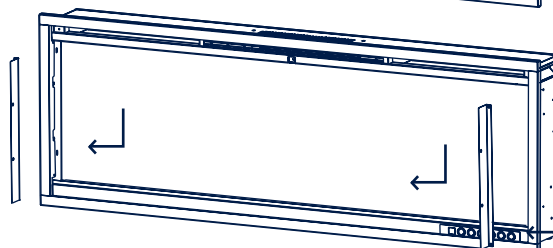

### STEP 6

- › It is highly recommended that **two people** complete this step.
- › Lift the fireplace and insert into the framed opening. Use your bubble level to level the fireplace within the framing and adjust as needed.
- › Drive four screws through the mounting holes located on each side as shown in Figure 7.
- › Add the decorations (see page 10) and re-install the glass front on the fireplace. (Figure 8)

7

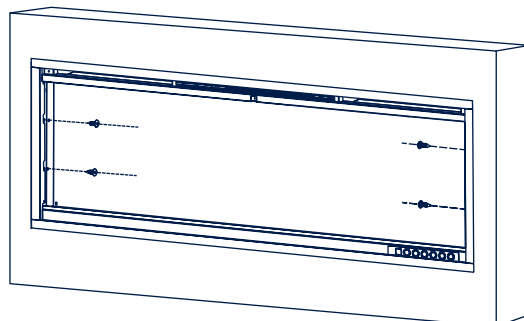

8

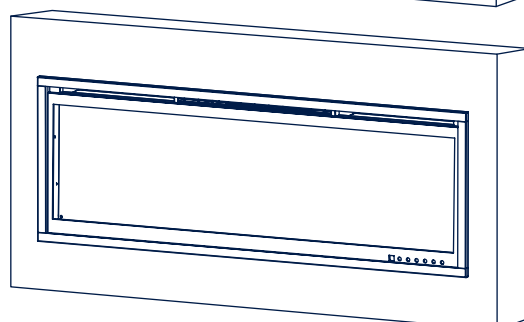



# INSTALLATION & ASSEMBLY

## WALL MOUNTED INSTALLATION

- › Due to the many different materials used on different walls, it is highly recommended that you consult your local builder before you install this appliance on the wall.
- › **You need two people to install the fireplace on a wall.**

### STEP 1

- › Select a location that is not prone to moisture and is located at least 36" (914mm) away from combustible materials such as curtain drapes, furniture, bedding, paper, etc.

### STEP 2

- › Have two people hold the appliance against the wall to determine the final location.

### STEP 3

- › Place unit face down on a soft, nonabrasive surface. Remove the bracket from the back of the unit by removing the screws.

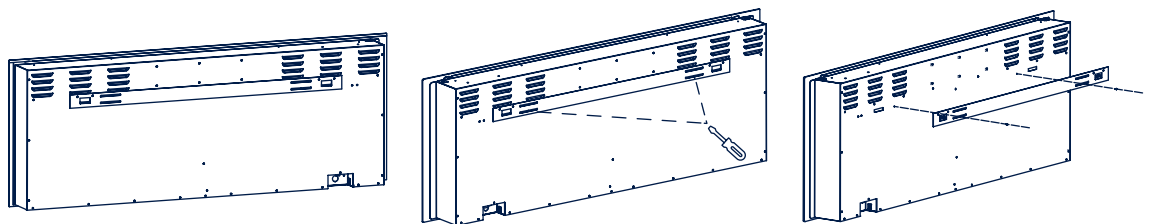
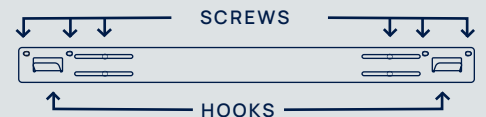

- › Illustration of wall bracket for models 1020 (40\"), 1280 (50\"), 1530 (60\"), 1830 (72\"), 2140 (84\")

### STEP 4

- › Mark out location, then mount the bracket(s) onto the wall using the supplied screws. This bracket **MUST** have the hooks facing upward and be level.

### ⚠ CAUTION

- › It is strongly recommended that the mounting bracket be screwed into the wall studs where possible. If the wall studs cannot be used, ensure that the supplied plastic anchors are used to affix the bracket to the wall and the bracket is adequately secured.

### STEP 5

- › With the wall mounting bracket installed have two people lift the appliance up and insert the two hooks on the bracket into the two slots on the back of the appliance.

### STEP 6

- › Check the appliance for stability ensuring that the bracket will not pull free from the wall.

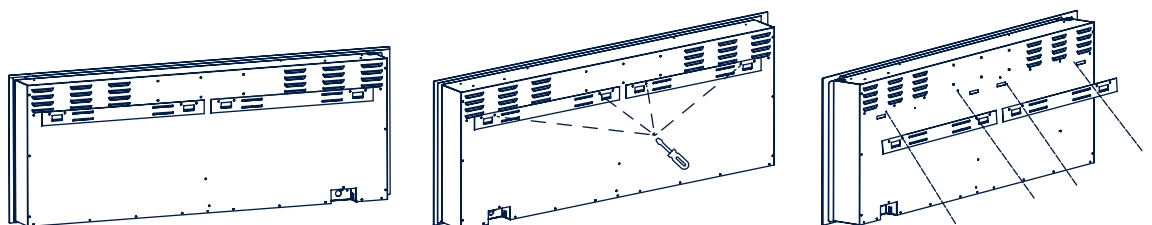

- › Illustration of wall bracket for model 2540 (100\")

## INSTALLATION & ASSEMBLY

### WALL MOUNTED INSTALLATION - "L" SHAPE BRACKET INSTALLATION

#### NOTICE

- › Only used for wall mounted installation!



1x Wood Screws



1x Drywall anchors

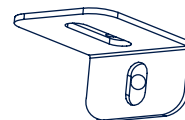

1x L Shape Bracket

#### STEP 1

- › Remove the silver screw at the bottom of the appliance. Set the screw aside. (Figure 1)

1

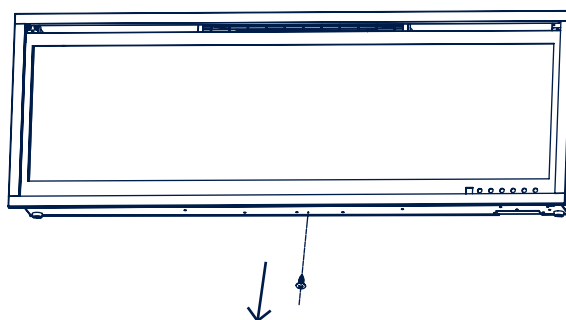

#### STEP 2

- › Using the screw previously removed, attach the L-bracket (supplied) to the bottom of the fireplace box. (Figure 2)

2

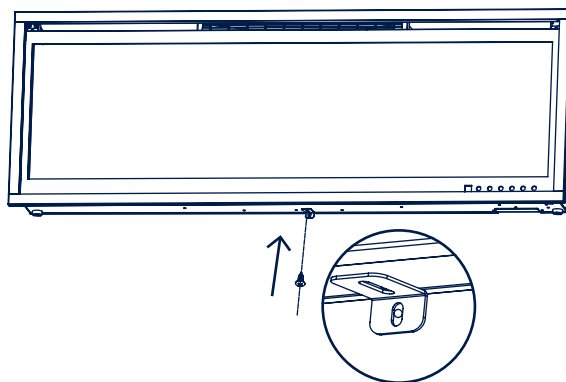

#### STEP 3

- › Install the plastic anchor into the drywall.
- › Then install the screw into the hole of the **L-bracket** into the wall anchor to secure the fireplace from coming off the bracket. (Figure 3)

3

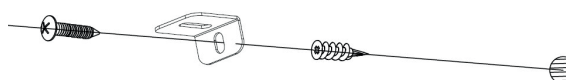

## DECORATIVE MEDIA

PLEASE PERFORM THE INSTALLATION ACCORDING TO YOUR PREFERRED MEDIA

### NOTICE

- › The glass front must be removed and the appliance must be mounted in its final location before the decorative media is installed.

## LOGSET

### STEP 1.1

- › **Logset:** Remove packaging and protecting foams from the logset and put it back into the fireplace.

### NOTICE

- › The plastic strip supplied must not be placed under the logset.

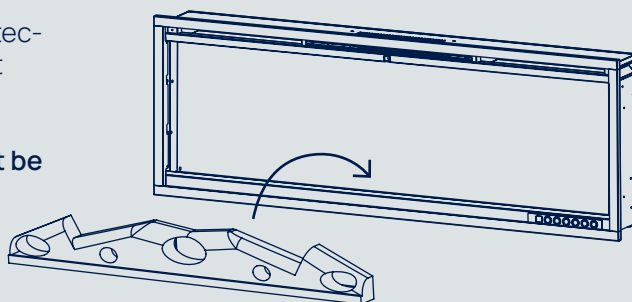

## CRYSTALS

### STEP 1.2

- › **Crystals:** Remove the logset from the fireplace
- › Place the plastic strip (included) in the fireplace.
- › Carefully place the decorative crystals into the strip. Apply an even layer from side to side.

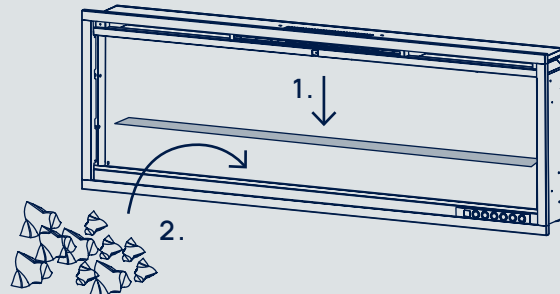

### NOTICE

- › The following steps must be carried out regardless of the type of the decorative material.

### STEP 2

- › Reinstall the glass front.

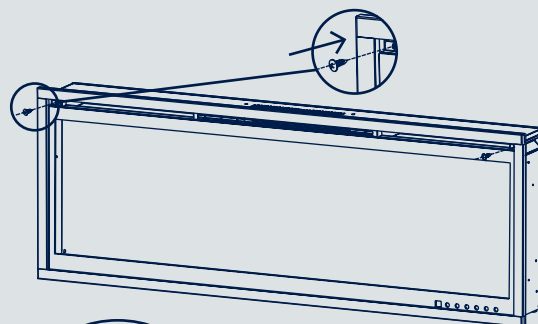

### STEP 3

- › Place the two metal covers (D) over the screws. Pre-installed magnets in the fireplace will keep the covers secure.

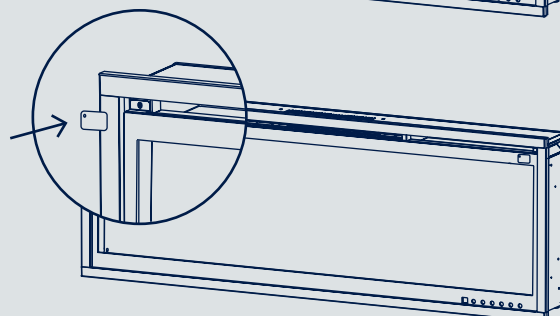

## OPERATION

### ⚠ CAUTION

- › Read and understand this entire owner's manual, including all safety information, before plugging in or using this product. Failure to do so could result in electric shock, fire, serious injury, or death.

### POWER

- › Plug the power cord into a **AC 220 Volt outlet** (see IMPORTANT SAFETY INFORMATION on Pages 2 and 3). Make sure the outlet is in good condition and that the plug is not loose. **NEVER exceed the maximum amperage for the circuit. DO NOT plug other appliances into the same circuit.**

### NOTICE

- › When the heater is first turned on, a slight odor may be present. This is normal and should not occur again unless the heater is not used for a long period of time.

### NOTICE

- › To improve operation, aim the remote control at the front of the fireplace. **DO NOT** press the buttons too quickly. Give the unit time to respond to each command.

### METHODS OF OPERATION

- › This electric fireplace can be operated by the TOUCH PANEL, located on the **BOTTOM right side** glass panel of the fireplace, or by the battery-powered **REMOTE CONTROL**.
- › Before operating, please review the **IMPORTANT SAFETY INFORMATION** on Pages 2 and 3, and heed all warnings.

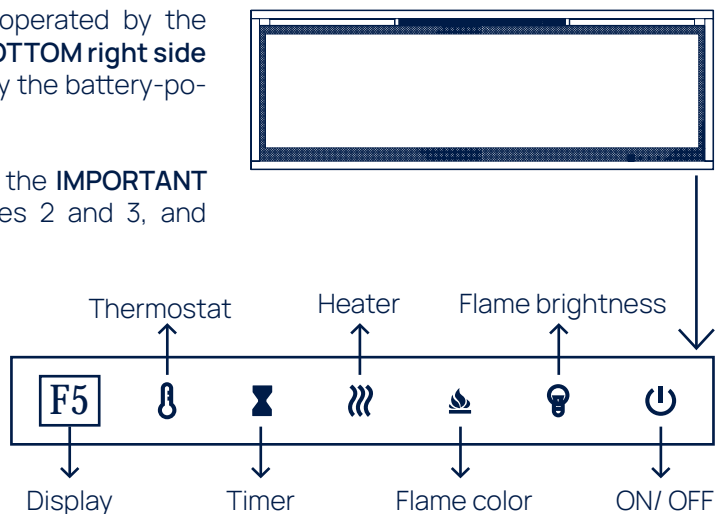



## HOTEL-MODE



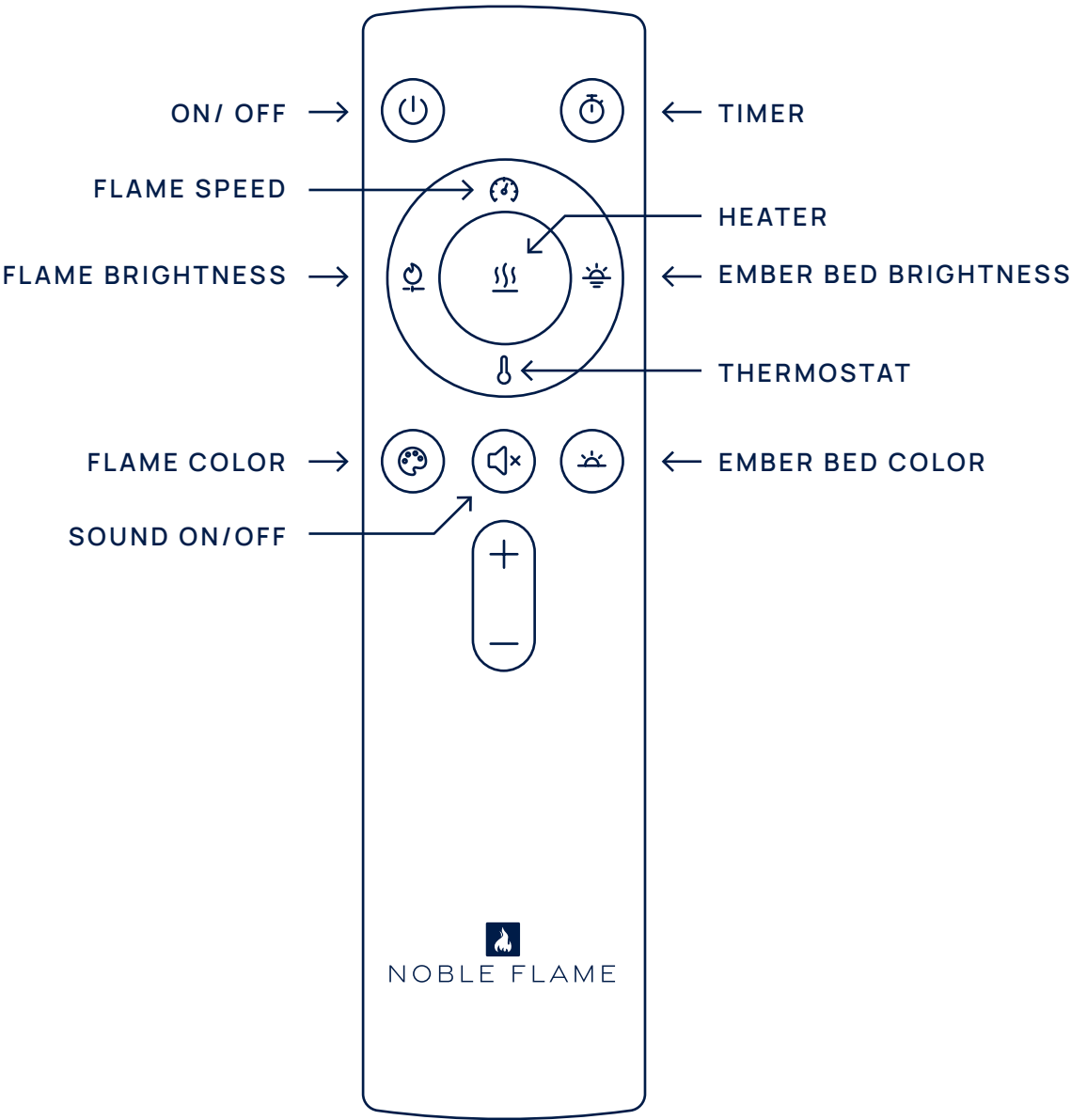

- › By using this mode, your individual settings for the following functions will be retained not only after you turn off the power on the touch panel or remote control, but also when you disconnect the power:
  - › **Flame color and brightness**
  - › **Flame speed**
  - › **Ember bed color and brightness**
  - › **crackling sound volume**
- › The settings for heating, temperature and timer are not saved and are automatically reset to default after power off.

REMOTE CONTROL







BUTTON	FUNCTION	ACTION & INDICATION
 POWER	<p><b>ON:</b> Enables control panel functions and remote control. Turns on flame effect.</p> <p><b>OFF:</b> Disables control panel functions and remote control. Turns off flame effect.</p>	<ol style="list-style-type: none"><li><b>Press once:</b> Indicator light turns on. Power turns on. All functions enabled.</li><li><b>Press again:</b> Flame effect turns off. Unit goes to standby. All functions turn off.</li></ol>
 TIMER	<p><b>TIMER BUTTON:</b> Controls timer settings to turn off fireplace at selected time.</p> <p><b>Settings range from 0.5 hours to 8 hours.</b></p>	<ol style="list-style-type: none"><li><b>Press once:</b> Indicator light turns on.</li><li><b>Press again until desired setting is reached.</b> Indicator lights show setting.</li></ol>

REMOTE CONTROL

BUTTON	FUNCTION	ACTION & INDICATION																								
<div> FLAME BRIGHT- NESS</div>	<p><b>FLAME-BRIGHTNESS BUTTON:</b> Makes flame effect dimmer and brighter.</p> <p><b>NOTE:</b> Flame effect stays on until power button is turned off. Flame effect must be on for heater to turn on.</p>	<div><div>1. <b>Press once:</b> Flame brightness starts changing.</div><div>2. <b>Press again</b> until desired setting is reached. There is a total of <b>6 settings</b>.</div></div>																								
<div> FLAME- COLOR</div>	<p><b>FLAME-COLOR BUTTON:</b> Changes color of the flame effect.</p> <p><b>NOTE:</b> color effect stays on until power button is turned off. Color flame effect must be on for heater to turn on.</p>	<div><div>1. <b>Press once:</b> Flame color starts changing.</div><div>2. <b>Press again</b> until desired setting is reached. There is a total of <b>6 flame colors</b>.</div></div>																								
<div> HEATER</div>	<p><b>HEATER BUTTON:</b> Turns Heater <b>ON</b> and <b>OFF</b>.</p> <p><b>NOTE:</b> The heater only works when the flame effect is on. If the flame effect is off, the heater will not turn on.</p> <p><b>NOTE:</b> To prevent overheating, the heater fan will blow cool air for 10 seconds before the heater turns on, and after the heater turns off.</p>	<div><div>1. <b>Press once:</b> Indicator lights up. Fan blows cool air for 10 seconds. 750W heater turns on and blows warm air.</div><div>2. <b>Press again:</b> Indicator lights up. 1500W heater turns on and blows hot air.</div><div>3. <b>Press again:</b> Heaters turn off. The fan blows cool air for 10 seconds to allow heater to cool down, then turns off.</div></div>																								
<div> THERMOS- TAT</div>	<p><b>THERMOSTAT BUTTON:</b> Changes the temperature settings.</p> <p><b>NOTE:</b> The heater turns off when the desired temperature is reached.</p> <p><b>NOTE:</b> Press the button for 5 seconds to switch between C° and F°.</p>	<div><div>1. <b>Press once:</b> The touch panel indicator becomes active.</div><div>2. <b>Press again:</b> until the desired temperature setting is reached. The display shows settings as below:</div></div>																								
TEMPERATURE/ DISPLAY		<table><tr><td>C°</td><td>20</td><td>21</td><td>22</td><td>23</td><td>24</td><td>25</td><td>26</td><td>27</td><td>28</td><td>29</td><td>30</td></tr><tr><td>F°</td><td>68</td><td>70</td><td>72</td><td>74</td><td>76</td><td>78</td><td>80</td><td>82</td><td>84</td><td>86</td><td>88</td></tr></table>	C°	20	21	22	23	24	25	26	27	28	29	30	F°	68	70	72	74	76	78	80	82	84	86	88
C°	20	21	22	23	24	25	26	27	28	29	30															
F°	68	70	72	74	76	78	80	82	84	86	88															

## REMOTE CONTROL

BUTTON	FUNCTION	ACTION & INDICATION
 <b>EMBER BED BRIGHTNESS</b>	<b>EMBER BED BRIGHTNESS BUTTON:</b> Makes ember bed light dimmer and brighter.  <b>NOTE:</b> L1 = brightness cycle	<ol style="list-style-type: none"> <li><b>Press once:</b> Ember bed brightness starts changing.</li> <li><b>Press again</b> until desired setting is reached. There is a total of <b>5 settings (L0-L5)</b>.</li> </ol>
 <b>EMBER BED COLOR</b>	<b>EMBER BED COLOR BUTTON:</b> Changes the color of the ember bed light.  <b>NOTE:</b> Ember bed color effect stays on until power button is turned off.  <b>NOTE:</b> 11 = auto cycle 12 = locks current color	<ol style="list-style-type: none"> <li><b>Press once:</b> Ember bed color starts changing.</li> <li><b>Press again</b> until desired setting is reached. There is a total of <b>12 ember bed color settings</b>.</li> </ol>
 <b>FLAME SPEED</b>	<b>FLAME SPEED BUTTON:</b> Controls the speed of the flame.  There are 4 flame speed settings: <ul style="list-style-type: none"> <li>&gt; 01 (slowest)</li> <li>&gt; 02 (medium)</li> <li>&gt; 03 (fast)</li> <li>&gt; 04 (fastest)</li> </ul>	<ol style="list-style-type: none"> <li><b>Press once:</b> Flame speed starts changing.</li> <li><b>Press again</b> until the desired setting is reached. The default setting is <b>02 (medium speed)</b>.</li> </ol>
 <b>SOUND</b>	<b>SOUND BUTTON:</b> Controls the crackling sound. There are 4 settings: <ul style="list-style-type: none"> <li>&gt; high</li> <li>&gt; medium</li> <li>&gt; low</li> <li>&gt; off</li> </ul> <b>NOTE:</b> Default setting is medium when turned on.	<ol style="list-style-type: none"> <li><b>Press once:</b> Crackling sound goes to lower setting.</li> <li><b>Press again:</b> Crackling sound goes off.</li> </ol>

## APP-CONTROL

### STEP 1

- > Download the Noble Home app from the App Store or Play Store by scanning the following QR Code.

### STEP 2

- > Follow the instructions there to control your device via the app.



## ADDITIONAL BLUETOOTH SPEAKER

- › The additional bluetooth speaker lets you listen to your favorite music whilst also enjoying the crackling of your fireplace.

### NOTICE

- › **One device for one connection.** If you want to connect with another device, firstly you must turn off the current connection.

### STEP 1

- › Use your mobile phone or other devices to search for the bluetooth signal of the fireplace.

### STEP 2

- › Connect your phone or other device to the bluetooth speaker.

### STEP 3

- › You will hear a sound from the speaker after your device is successfully connected.

### STEP 4

- › The bluetooth speaker is ready for use.

## TEMPERATURE LIMITING CONTROL

### NOTICE

- › This heater is equipped with a Temperature Limiting Control. Should the heater reach an unsafe temperature, the heater will automatically turn OFF.

### TO RESET

1. Turn the ON/OFF switch on the CONTROL PANEL to OFF. Wait 5 minutes.
2. Unplug the power cord from the outlet.
3. Inspect the fireplace to make sure no vents are blocked or clogged with dust or lint. If they are, use a vacuum to clean the vent areas.
4. With the POWER switch in the OFF position, plug the power cord back into the outlet.
5. If the problem continues, have your outlet and wiring inspected by a professional.

## REMOTE CONTROL BATTERY INFORMATION

- › The remote control uses **two AAA batteries** (not included).

### CAUTION

- › **NEVER dispose of batteries in fire.**
- › Failure to observe this precaution may result in an explosion. Dispose of batteries at your local hazardous material processing center.



## CARE & MAINTENANCE

### CLEANING

#### ⚠ CAUTION

- › **ALWAYS** turn the heater **OFF** and unplug the power cord from the outlet before cleaning, performing maintenance, or moving this fireplace. **Failure to do so could result in electric shock, fire, or personal injury.**
- › **NEVER immerse in water or spray with water.** Doing so could result in electric shock, fire, or personal injury.

#### METAL

- › Buff using a soft cloth, slightly dampened with a citrus oil-based product.
- › **DO NOT** use brass polish or household cleaners as these products will damage the metal trim.

Get the cleaner here



#### GLASS

- › Use a good quality glass cleaner sprayed onto the cloth or towel. Dry thoroughly with a paper towel or lintfree cloth.
- › **NEVER** use abrasive cleansers, liquid sprays, or any cleaner that could scratch the surface.

#### VENTS

- › Use a vacuum or duster to remove dust and dirt from the heater and vent areas.

#### PLASTIC

- › Wipe gently with a slightly damp cloth and a mild solution of dish soap and warm water.
- › **NEVER** use abrasive cleansers, liquid sprays, or any cleaner that could scratch the surface.

## MAINTENANCE

#### ⚠ CAUTION

- › **Risk of electric shock! DO NOT OPEN any panels ! No user-serviceable parts inside!**
- › **ALWAYS** turn the heater **OFF** and unplug the power cord from the outlet before cleaning, performing maintenance, or moving this fireplace. Failure to do so could result in electric shock, fire, or personal injury.

#### ELECTRICAL AND MOVING PARTS

- › The fan motors are lubricated at the factory and will not require lubrication.
- › Electrical components are integrated in the fireplace and are not serviceable by the consumer.

#### STORAGE

- › Store heater in a clean dry place when not in use.

#### ⚠ CAUTION

- › **NO SERVICING of the internal or electrical parts should be performed by the consumer. Do not service the unit yourself.**